

*the*  
**GANZHORN SUITES**  
Specialized Memory Care

*Family Centered. Physician Connected.*





## *The Ganzhorn Difference*

At The Ganzhorn Suites, we focus on innovation in care, technology and residential design. We are among the very few specialized memory care assisted living centers with the ability to provide complex medical care to residents in the later stages of Alzheimer's disease.

This focus, along with our heartfelt determination to make a difference in the lives of those we serve, is what makes our community different from any other memory care community you'll find.



## Evidence-Based Approach

We believe resident-centered memory care services ensure the best possible environment for our residents. Our clinical outcomes, benchmarked to national data, demonstrate our exceptional care. Led by a nationally renowned neurologist, our memory care programming is based on the latest Alzheimer's research findings and evidence-based care practices.

## Advanced Technologies

Our state-of-the-art technologies provide the safest, most secure living environment possible for our residents. We offer:

- Sophisticated safety and monitoring devices that immediately alert caregivers of residents' needs and activities, allowing maximum freedom in a protected environment
- Customized web-based memory tools and programs to keep families and residents connected
- Electronic medical records to facilitate communication with physicians and other health care providers

## Purpose-Built Design

Our center reflects innovation in environmental design, considering the impact of light, sounds, color and textures on residents with memory loss and incorporating only safe, soothing design elements. Serene spaces, private suites, natural light, circular paths and simple décor with memory cues combine to create a comforting, easy-to-navigate environment.

The Ganzhorn Suites offers four small households, each with a kitchen, living room and den. These households are built around beautifully designed tranquility gardens that provide opportunities for residents to enjoy the outdoors.

## Specially Trained Team & High Staff-to-Resident Ratios

Our care team includes Certified Dementia Practitioners® (CDP) who passionately dedicate each day to providing life-enriching care to our residents. This is an earned credential that recognizes the highest standard in Alzheimer's and dementia care practices.

Families take comfort in knowing we have one of the highest staff-to-resident ratios found in a memory care assisted living center. For residents, this means more attentive, personalized services. And, because our team members consistently provide care to the same small group of residents, strong bonds form between caregivers, residents and families.





## PURPOSEFUL LIVING

At The Ganzhorn Suites, we believe purposeful living is achieved by engaging *with* our residents, rather than just doing things *for* our residents. We take moments during care to use conversation techniques and touch to spark memories. This approach helps to create positive reactions that keep residents engaged and connected.

Purposeful living and enrichment opportunities are in every interaction we share with our residents – something especially important when caring for those with memory loss.

At The Ganzhorn Suites, everyday moments are seen as opportunities to create meaningful experiences that provide our residents with a sense of identity. Even the simplest activity can be beneficial and worthwhile.



# RESPIRE CARE

We understand how challenging caring for someone at home with Alzheimer's disease can be for a family member. It requires nonstop care both physically and emotionally, which can make it difficult to find time for other parts of your life, such as family, leisure and personal well-being. Whether you're dealing with a family emergency, planning a vacation or simply need a break, our short-term respite program is the ideal solution.

At The Ganzhorn Suites, we provide comprehensive care with an emphasis on safety, security and personalized services. Program highlights include:

- A team of Certified Dementia Practitioners®
- Exceptional staffing levels – nearly twice the levels found at typical memory care centers
- Furnished private suites with full private baths
- Four distinct households, each with a kitchen, dining room, living room and den
- Advanced safety and monitoring technologies
- Tranquility garden with circular walking paths
- Beauty salon and barber shop
- Spa



## RESPIRE CARE DAILY RATE

Our respite care daily rate is all-inclusive and covers:

- Furnished private suite with private bath
- All clinical care and services
- Medication management and distribution
- Medical supplies
- Personal care items, including incontinence products
- All meals, snacks and supplements

**Respite Care: \$295 per day**

\*For more information, contact our Community Relations Director at 614-356-9810.



*the*  
**GANZHORN SUITES**  
Specialized Memory Care

844-683-CARE (2273) or 614-356-9810 | [www.ganzhorn.com](http://www.ganzhorn.com)  
10272 Sawmill Parkway | Powell, OH 43065





## DINING EXPERIENCE

### Dining . . . At Your Service

Recognizing that those living with Alzheimer's disease and other memory issues are at a higher risk of experiencing nutritional deficiencies, we've created a program designed to meet their specific dietary needs. Menus are created by a specially trained dietitian and feature fresh foods with a focus on high nutritional content.

Our dining program provides not only delicious and nutritious daily meals, but also a positive experience that promotes greater socialization and independence.

As cognitive functioning declines, residents may experience difficulty eating with utensils, so we incorporate small, bite-size portions that can be eaten easily without utensils to encourage independence and preserve dignity. To avoid the distraction of large and noisy dining rooms, each of our households features its own kitchen and intimate dining area to promote comfort and a feeling of familiarity.

At The Ganzhorn Suites, our residents dine when they want to. If a resident wakes up late, a member of our care team can make breakfast right in the household. If a resident wakes up in the middle of the night and wants a snack, our staff can prepare a nutritious snack that satisfies their craving. We work around residents' schedules, not what is convenient for us.



*the*  
**GANZHORN SUITES**  
Specialized Memory Care

844-683-CARE (2273) or 614-356-9810

[www.ganzhorn.com](http://www.ganzhorn.com) | 10272 Sawmill Parkway | Powell, OH 43065



# FLOOR PLANS

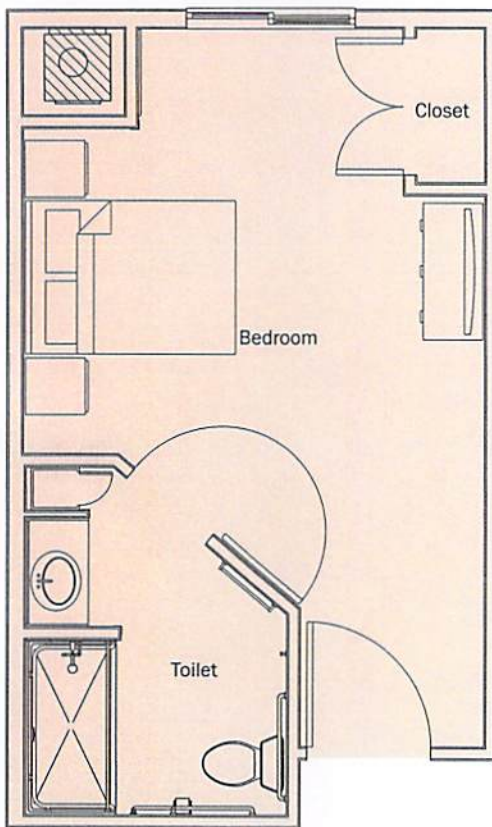

SUITE | 209-227 SQ. FT.

At The Ganzhorn Suites, we offer 64 spacious, private suites. Each suite reflects careful research and thoughtful planning in the area of Alzheimer's and dementia care. In addition to providing a therapeutic environment, our suites offer all the comfort and elegance of your family's own home.

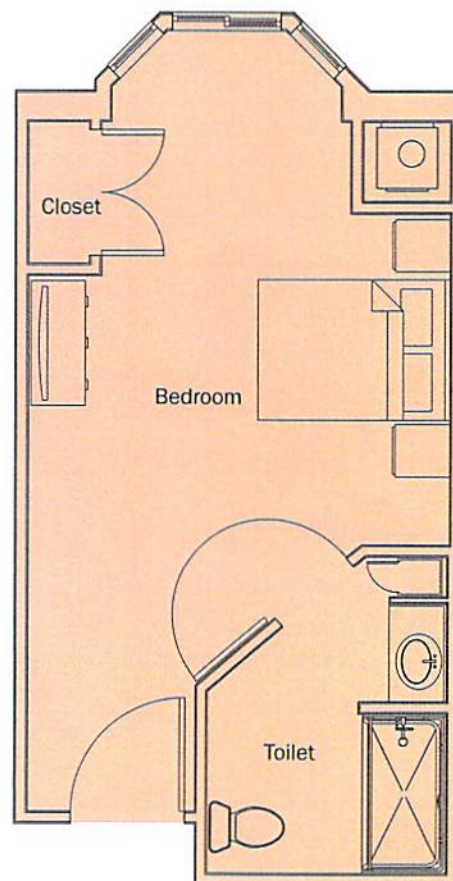

SUITE PLUS | 234-245 SQ. FT.



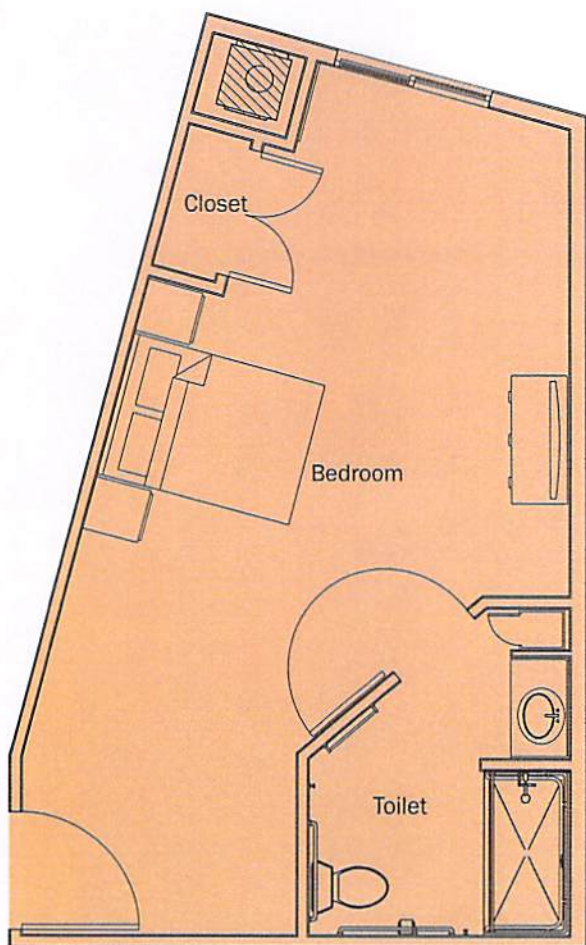

DELUXE SUITE | 302 SQ. FT.

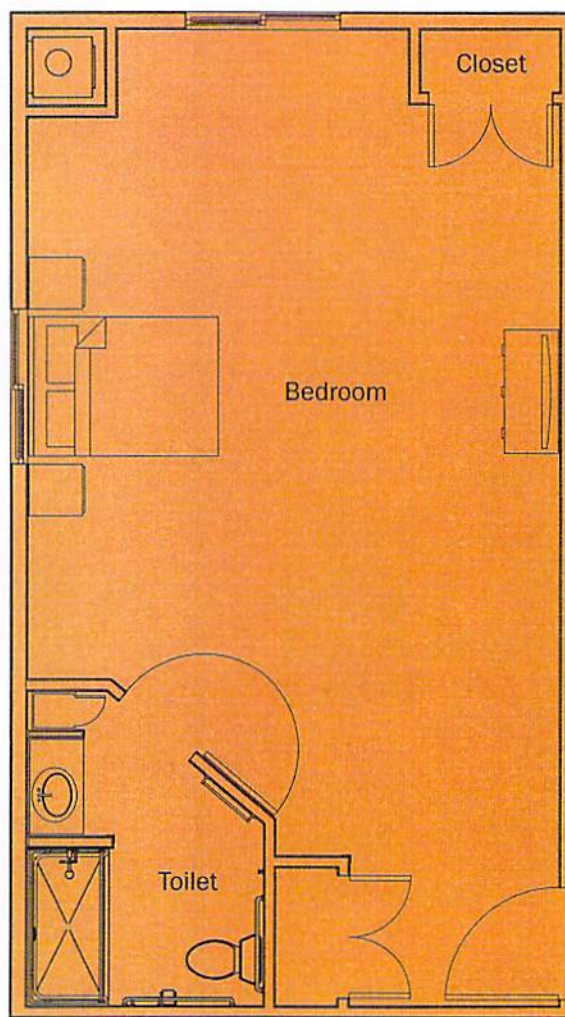

LUXURY SUITE | 443 SQ. FT.



# FEATURES, AMENITIES & RATES

The Ganzhorn Suites provides comprehensive care with an emphasis on safety, security and personalized services for those living with Alzheimer's disease and dementia. Our monthly rates include 24-hour care and programs specifically tailored to fit each resident's individual needs and abilities, as well as an array of services and amenities.

## FEATURES & AMENITIES

- Furnished private suites with private baths
- Four distinct households, each with a kitchen, dining room, living room and den
- Nurses on site 24/7
- A team of Certified Dementia Practitioners®
- Exceptional staffing levels – nearly twice the typical levels found at memory care centers
- Advanced safety and monitoring technologies
- Personalized enrichment programs
- Rehabilitation services
- Tranquility gardens with walking paths
- Beauty salon and barber shop
- Spa
- WiFi

## Our monthly rates are all-inclusive and provide:

- All clinical care and services – no additional level-of-care charges
- Medical supplies
- Medication management and distribution of medications
- All meals and snacks
- Furnished private suite with private bath
- Housekeeping and laundry services
- All utilities, including internet access

## MONTHLY RATES

Suite – \$7,950

Suite Plus & Garden View Suites – \$8,250

Deluxe Suite – \$9,250

Luxury Suite – \$11,425

Shared Luxury Suite – \$6,950

One-Time Community Fee – \$1,000



*the*  
**GANZHORN SUITES**  
Specialized Memory Care

844-683-CARE (2273) or 614-356-9810 | [www.ganzhorn.com](http://www.ganzhorn.com)  
10272 Sawmill Parkway | Powell, OH 43065







*the* **GANZHORN SUITES**  
Specialized Memory Care

Anne Farley, LSW, MS Counseling  
*Community Relations Director*

10272 Sawmill Parkway | Powell, OH 43065  
(614) 356-9813 | (614) 398-9333 Cell  
CRD.Powell@ganzhorn.com







*the*  
**GANZHORN SUITES**  
Specialized Memory Care

844-683-CARE (2273)

614-356-9810

[www.ganzhorn.com](http://www.ganzhorn.com)

10272 Sawmill Parkway | Powell, OH 43065

